

# Product information

## Digital workshop caliper MarCal 18 EWRI

### Product features

- High contrast digit display
- Locking screw above
- Rounded measuring blades for inside measurements
- Slide and beam made of hardened stainless steel
- Immediate measurements due to the Reference System
- Raised guideway for the protection of the scale
- Excellent resistance against dust, coolants and lubricants
- Dirt wipers are integrated in the slide



Item no.: **4112572**

### Functions

ON/OFF, AUTO-ON / OFF, HOLD (freeze current measured value), RESET (set display to zero), PRESET (for entering a numerical value), Reversal of counting direction, mm/inch, LOCK function (key lock), DATA (data transmission)

### Technical data

<b>Measuring range mm</b>	0 - 500
<b>Measuring range</b>	0 - 20"
<b>Resolution mm/inch</b>	0.01 / .0005"
<b>Error limit (mm)</b>	0.04 mm
<b>Height of digits</b>	12.5 mm
<b>Battery type</b>	CR 2032 (3V Lithium)

### Package contains

battery, test certificate, instruction manual, case

### Data interface

Integrated Wireless

### Dimensions

<b>Dimensions e in mm</b>	25 mm
<b>Dimensions b in mm</b>	150 mm
<b>Dimensions a in mm</b>	650 mm
<b>Dimensions f in mm</b>	55 mm
<b>Dimensions c in mm</b>	20 mm
<b>Dimensions d in mm</b>	20 mm

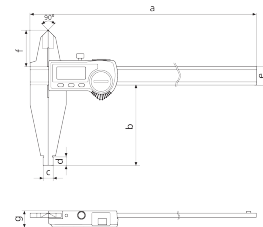

### Accessories

Order no.	Designation	Product type
4102220	Wireless receiver for measuring instruments with integrated wireless	i-Stick