

Product information

Digital workshop caliper MarCal 18 EWRI

Product features

- High contrast digit display
- Locking screw above
- Rounded measuring blades for inside measurements
- Slide and beam made of hardened stainless steel
- Immediate measurements due to the Reference System
- Raised guideway for the protection of the scale
- Excellent resistance against dust, coolants and lubricants
- Dirt wipers are integrated in the slide



Item no.: **4112571**

Functions

ON/OFF, AUTO-ON / OFF, HOLD (freeze current measured value), RESET (set display to zero), PRESET (for entering a numerical value), Reversal of counting direction, mm/inch, LOCK function (key lock), DATA (data transmission)

Package contains

battery, test certificate, instruction manual, case

Data interface

Integrated Wireless

Technical data

Measuring range mm	0 - 300
Measuring range	0 - 12"
Resolution mm/inch	0.01 / .0005"
Error limit (mm)	0.03 mm
Height of digits	12.5 mm
Battery type	CR 2032 (3V Lithium)

Dimensions

Dimensions e in mm	20 mm
Dimensions b in mm	90 mm
Dimensions a in mm	430 mm
Dimensions f in mm	40 mm
Dimensions c in mm	10 mm
Dimensions d in mm	10 mm

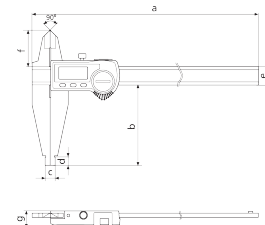

Accessories

Order no.	Designation	Product type
4102220	Wireless receiver for measuring instruments with integrated wireless	i-Stick