

# Product information

## Digital special calipers MarCal 16 EWRI-AI

### Product features

- High contrast digit display
- Locking screw above
- Lapped guideway
- Slide and beam made of hardened stainless steel
- Immediate measurements due to the Reference System
- Raised guideway for the protection of the scale
- Excellent resistance against dust, coolants and lubricants
- Dirt wipers are integrated in the slide



### Functions

ON/OFF, AUTO-ON / OFF, mm/inch, LOCK function (key lock), RESET (set display to zero), PRESET (for entering a numerical value), DATA (data transmission), HOLD (freeze current measured value)

### Package contains

battery, test certificate, instruction manual, case

### Application

Outward-angled measuring surfaces for measuring recesses in bores

### Data interface

Integrated Wireless

Item no.: 4103380

### Technical data

<b>Measuring range mm</b>	10 - 160 mm
<b>Measuring range</b>	0.4 - 6.3"
<b>Resolution mm/inch</b>	0.01 / .0005"
<b>Error limit (mm)</b>	0.03
<b>Height of digits</b>	11
<b>Battery type</b>	CR 2032 (3V Lithium)

### Dimensions

<b>Dimensions e in mm</b>	16
<b>Dimensions b in mm</b>	40
<b>Dimensions d in mm</b>	235

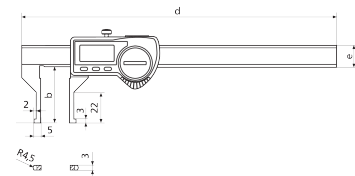

### Accessories

Order no.	Designation	Product type
4102220	Wireless receiver for measuring instruments with integrated wireless	i-Stick