

Product information

Digital special calipers MarCal 16 EWR-SA

Product features

- High contrast digit display
- Locking screw above
- Lapped guideway
- Slide and beam made of hardened stainless steel
- Immediate measurements due to the Reference System
- Raised guideway for the protection of the scale
- Excellent resistance against dust, coolants and lubricants
- Dirt wipers are integrated in the slide



Functions

ON/OFF, AUTO-ON / OFF, mm/inch, LOCK function (key lock), RESET (set display to zero), DATA (data transmission via connection cable)

Package contains

battery, test certificate, instruction manual, case

Application

Inward-angled measuring tips for measuring wall thicknesses and recesses on shafts

Data interface

USB, Opto RS-232C, Digimatic

Item no.: 4103077

Technical data

Measuring range mm	0 - 140 mm
Measuring range inch	0 - 6"
Resolution mm/inch	0.01 / .0005"
Error limit (mm)	0.03
Height of digits	8.5
Battery type	CR 2032 (3V Lithium)

Dimensions

Dimensions e in mm	16
Dimensions b in mm	40
Dimensions d in mm	235

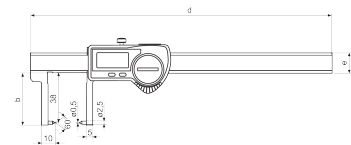

Accessories

Order no.	Designation	Product type
4102357	Data connection cable USB	16 EXu
4102915	Interface adapter with data cable Digimatic	16 EWd
4102410	Data connection cable RS232C	16 EXr